

Digital Control Panel For Electric Height Adjustable Desk

Installation Instruction & User Guide

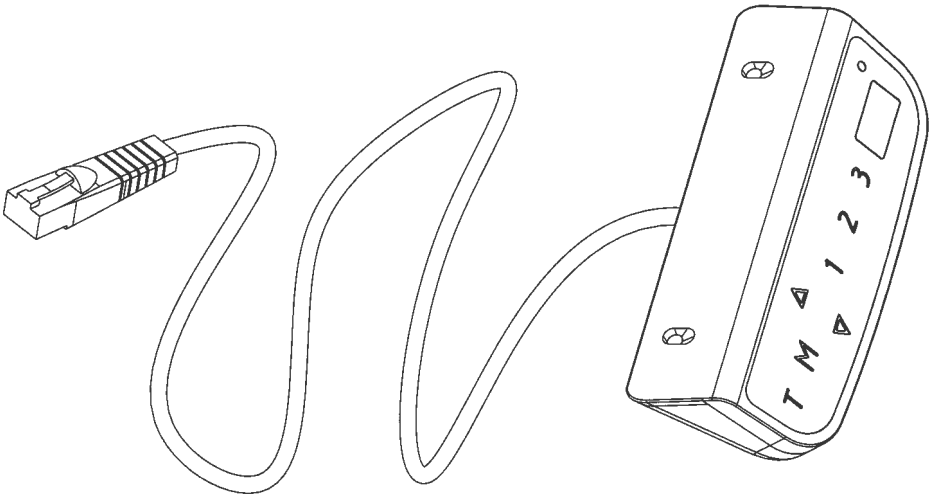

Model: CT-01

1

Operating Control Panel

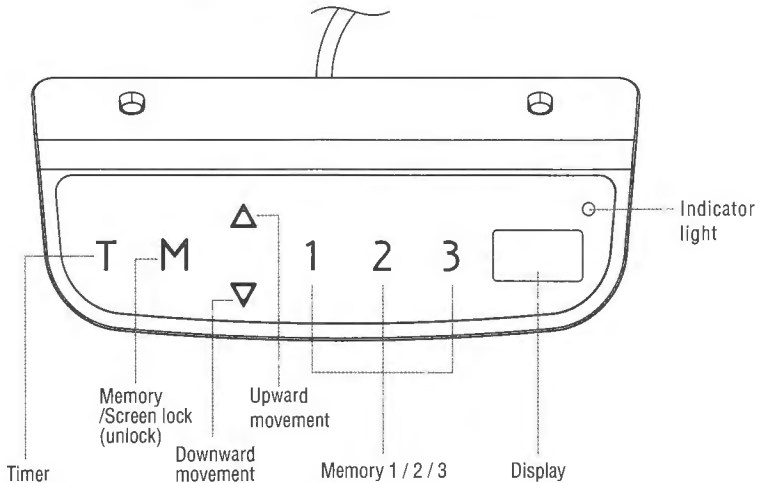

Operation Instruction:

Activate the System: Touch the screen. The “---” will appear on the display. Then, press and hold the “M” button for 3 seconds. The current height will display, and you can start operating the system.

Height Adjustment: Press and hold the up button to lift the desk. Press and hold the down button to lower the desk.

Timer: The timer is designed to inform users to stand up after a set period of time. Press the “T” button to set the period of time. The display will flash “0.5 h” for 0.5 hour. Each press of the “T” button leads to a 0.5 hour increment. The maximal setting of time is 2 hours. When the display stops flashing, then the period of time is successfully set. And the indicator light on the top right of panel will be on. When the set time is up, the buzzer will beep to remind the users. The timer will turn off automatically after a long beep. To cancel the timing, press “T” button for 5 times until the display shows the current height and the indicator light is off.

Memory Setting: Adjust the desk to your desired position. Press the “M” button, then “S” appears on the display. Press “1”, “2” or “3”. The memory is successfully set. You can store up to 3 heights by repeating the same process.

Protective Standby Mode: If there is no operation for 1 minute, the system will enter the protective standby mode. To turn off the standby mode, press and hold the “M” button for 3 seconds. You can also press and hold the “M” button for 3 seconds to activate the standby mode, when you don’t need to operate the system.

Power-saving Mode: When no actions are made for over 10 minutes, the system will enter power-saving mode. Press any buttons to enter operation mode.

Measurement Switch (cm/inch): Press “T” for 8s. The buzzer will beep twice. The measurement is changed from centimeter to inch. If you want to switch the measurement back to centimeter, also press the “T” for 8s.

Reset Mode: While the system is reconnected, press the down button until “RST” is displayed. Continue to press the button. The desk will move down and then raise a little bit. (Make sure you never release the button during the process.) After the movement stops, the system is successfully reset to the starting position.

2

Troubleshooting Guide

In Front

This repair guide intends to help you identify and solve the minor problems caused by unusual operation of the electric system of our sit-stand desk. The simple procedures in this manual are easy to follow and capable of solving the most problems happened in everyday use.

If **ER1/ER2/HOT/ER3/ER4/ER5** appear on the control panel, this is normally nothing to worry about, and usually is an indication that the system has experienced activity that is above rated specifications. Simply follow the steps below, most errors can be solved. If the problems aren't solved, please contact your point of purchase to replace components.

1. ER1 Troubleshooting

Step1: Check if the desk is overloaded. If so, remove the items on the desktop, and disconnect the power. If not, only disconnect the power.

Step2: Wait for 10s then reconnect the cord.

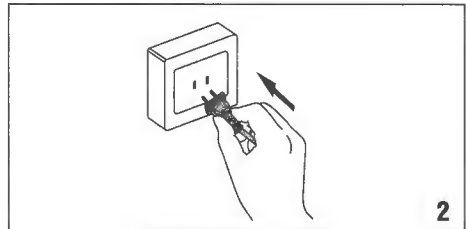
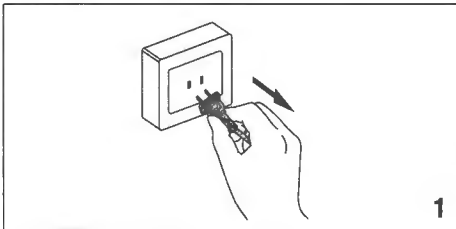

2. ER2/HOT Troubleshooting

Step1: The system has experienced above-normal temperature. So, allow your desk to cool down and remain idle for approximately 20minutes. Never turn off the power during the process.

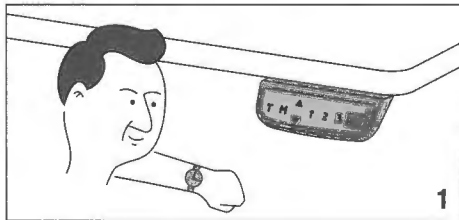

3. ER3/ER4/ER5 Troubleshooting

Step1: The system has experienced unusual electrical problems. Firstly, disconnect the motor cords and power.

Step2: Wait for 10s then reconnect the cords.

Step3: Press and hold the down button until the image appears, and continue to press the button. The desk will move down and then raise a little bit. (Make sure you never release the button during the process.)

Step4: Release the button after the movement stops.

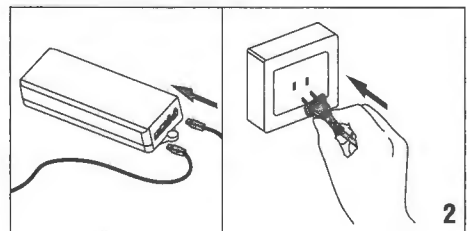
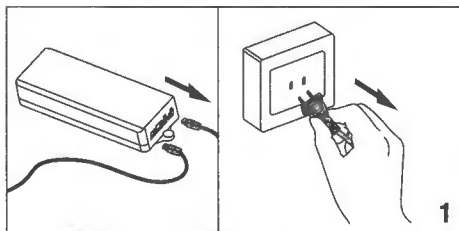

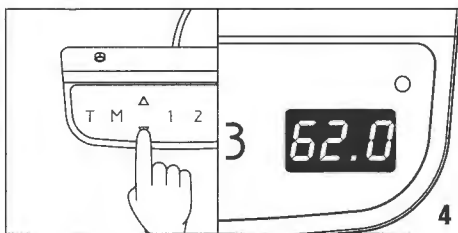
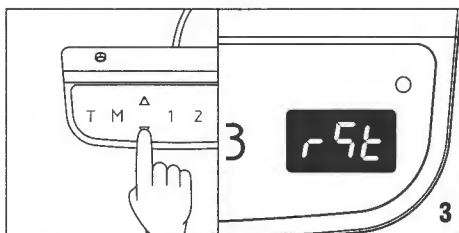

Other Problems:

1. Control Panel Problems

If the control panel has no response or can't adjust the desk, please contact your point of purchase to replace the control panel after confirming the desk is properly connected to power. If the new control panel works, please contact us to replace the original control panel. If the desk still doesn't work, please contact your point of purchase for service or repair to your unit.

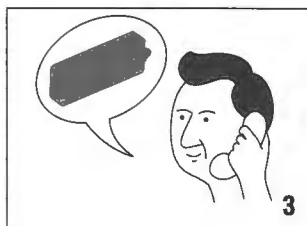
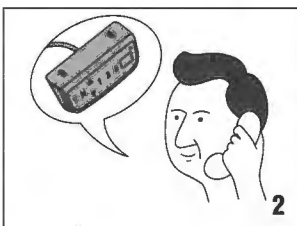
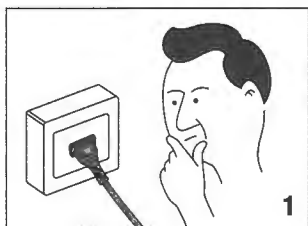

2. Lifting Columns Can't Operate

If the desk doesn't work, after confirming the control panel works properly, please turn the power off, and restart the system. If it still doesn't work, please contact your point of purchase for service or repair to your unit.

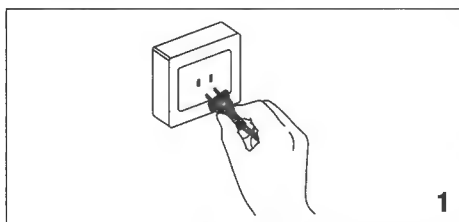

3. Overcurrent Protection

In addition, an over-current protection mode has been also programmed in this system. When the electricity is over rated specification, the system will enter this mode. The desk will lower approximately 30mm and stop with the height displayed if the mode activates. This is only an introduction of the function of the downward movement. No trouble shooting is required when this happens.